

MILESTONE COMMERCIAL REALTY



FOR SALE UNIQUE COMMERCIAL PROPERTY

**200 MACKALL ST
ELKTON, MARYLAND**

- 8.44 ACRES
- 37,984 sf BUILDING
- ZONED C-2, COMMERCIAL
- FRONTS ON BIG ELK CREEK
- ONE-OF-A-KIND PROPERTY
- PUBLIC UTILITIES

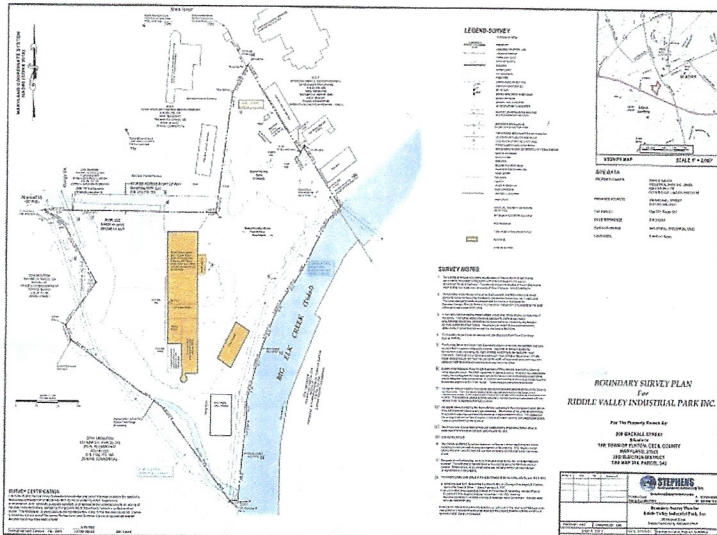

CALL:

RICK LEIPOLD, CCIM - # 410.441.4419

**Milestone Commercial Realty
P.O. Box 1218
Elkton, MD 21922-1218
410.620.5115
www.MilestoneCR.com**



LEGEND

- Organic
- NH₂ Bags
- Water Line
- Unknown Pipe
- Gas Line
- Sanitary Sewer
- Steel Pipe
- Steel Pipe - Sewer
- Boundary
- Access - Eastern Area
- Water Systems
- Water
- Electric

STEPHENS W.O. 1705.EA

11111 Stephens Ave
 P.O. Box 1705
 Stephens, GA 30284-1705

Project: Drone Utility Map
 Client: Drone Utility Map
 Date: 08/11/2022

Scale: 1" = 200'

Source: USDA NRCS, Cecil County, SECI





MARYLAND COORDINATE SYSTEM
NAD83 (EPOCH 2011)

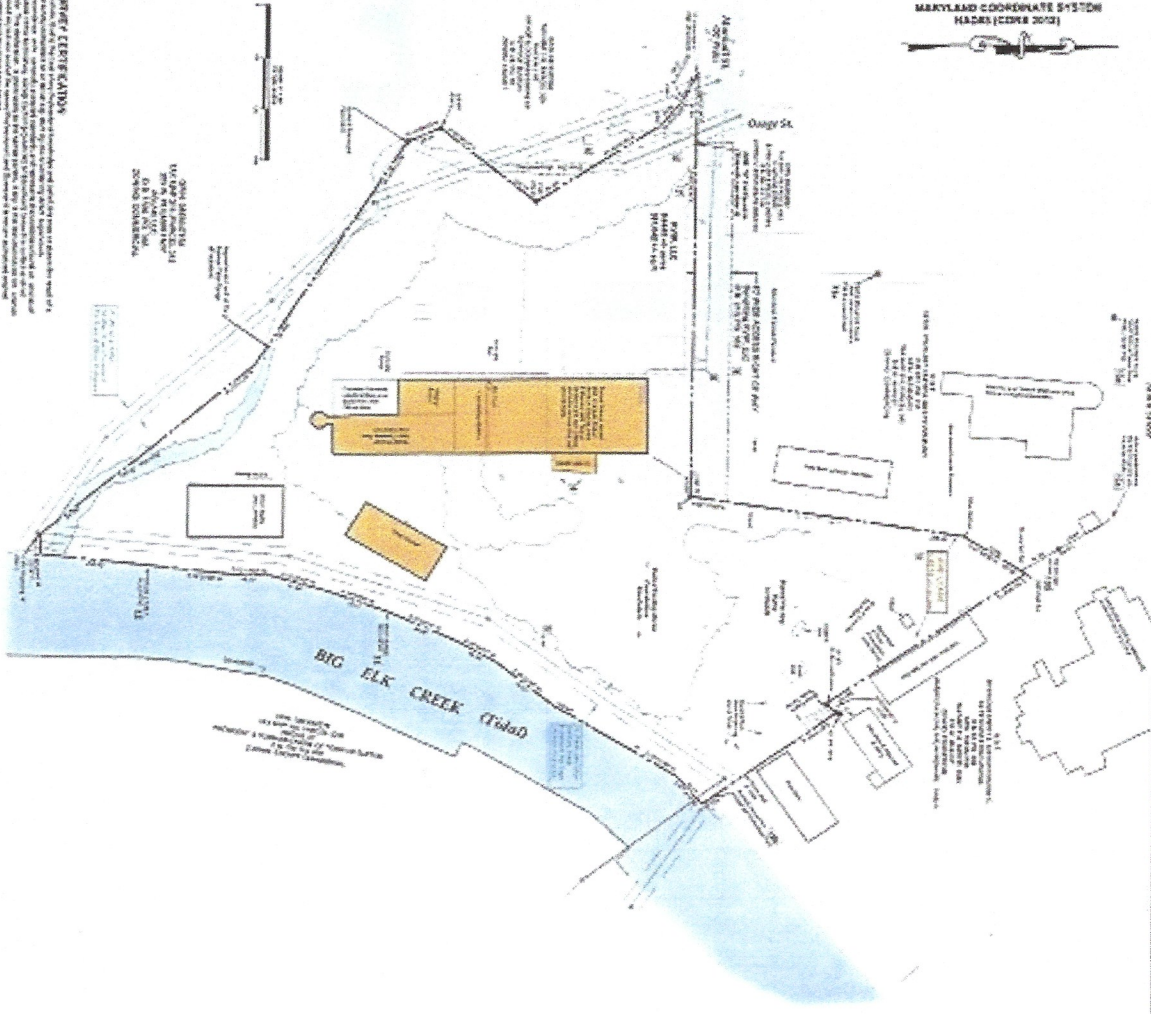

DATE: 08/14/2013
BY: J. H. HARRIS
PROJECT: RIDDLE VALLEY INDUSTRIAL PARK INC.
SHEET: 01 OF 01

SURVEY CERTIFICATION
I, J. H. HARRIS, State Registered Professional Engineer, No. 10000, State of Maryland, do hereby certify that I am the author of the above and foregoing plat, and that the same is a true and correct copy of the original as the same appears in my files.

LEGEND-SURVEY

- 1. Survey Boundary
- 2. Easement
- 3. Setback
- 4. Utility
- 5. Building
- 6. Parking Lot
- 7. Stream
- 8. Road
- 9. Fencing
- 10. Survey Point
- 11. Survey Line
- 12. Survey Area
- 13. Survey Station
- 14. Survey Control Point
- 15. Survey Monument
- 16. Survey Boundary
- 17. Survey Easement
- 18. Survey Setback
- 19. Survey Utility
- 20. Survey Building
- 21. Survey Parking Lot
- 22. Survey Stream
- 23. Survey Road
- 24. Survey Fencing
- 25. Survey Point
- 26. Survey Line
- 27. Survey Area
- 28. Survey Station
- 29. Survey Control Point
- 30. Survey Monument

SURVEY NOTES

1. This survey was conducted in accordance with the Maryland Surveying and Mapping Act of 1996, as amended.
2. The survey was conducted using a Trimble R6 GNSS receiver and a Leica TS16 total station.
3. The survey was conducted on August 14, 2013.
4. The survey was conducted by J. H. Harris, State Registered Professional Engineer, No. 10000, State of Maryland.
5. The survey was conducted for the purpose of establishing the boundary and easement lines for the Riddle Valley Industrial Park, Inc.
6. The survey was conducted in accordance with the Maryland Surveying and Mapping Act of 1996, as amended.
7. The survey was conducted using a Trimble R6 GNSS receiver and a Leica TS16 total station.
8. The survey was conducted on August 14, 2013.
9. The survey was conducted by J. H. Harris, State Registered Professional Engineer, No. 10000, State of Maryland.
10. The survey was conducted for the purpose of establishing the boundary and easement lines for the Riddle Valley Industrial Park, Inc.
11. The survey was conducted in accordance with the Maryland Surveying and Mapping Act of 1996, as amended.
12. The survey was conducted using a Trimble R6 GNSS receiver and a Leica TS16 total station.
13. The survey was conducted on August 14, 2013.
14. The survey was conducted by J. H. Harris, State Registered Professional Engineer, No. 10000, State of Maryland.
15. The survey was conducted for the purpose of establishing the boundary and easement lines for the Riddle Valley Industrial Park, Inc.
16. The survey was conducted in accordance with the Maryland Surveying and Mapping Act of 1996, as amended.
17. The survey was conducted using a Trimble R6 GNSS receiver and a Leica TS16 total station.
18. The survey was conducted on August 14, 2013.
19. The survey was conducted by J. H. Harris, State Registered Professional Engineer, No. 10000, State of Maryland.
20. The survey was conducted for the purpose of establishing the boundary and easement lines for the Riddle Valley Industrial Park, Inc.
21. The survey was conducted in accordance with the Maryland Surveying and Mapping Act of 1996, as amended.
22. The survey was conducted using a Trimble R6 GNSS receiver and a Leica TS16 total station.
23. The survey was conducted on August 14, 2013.
24. The survey was conducted by J. H. Harris, State Registered Professional Engineer, No. 10000, State of Maryland.
25. The survey was conducted for the purpose of establishing the boundary and easement lines for the Riddle Valley Industrial Park, Inc.
26. The survey was conducted in accordance with the Maryland Surveying and Mapping Act of 1996, as amended.
27. The survey was conducted using a Trimble R6 GNSS receiver and a Leica TS16 total station.
28. The survey was conducted on August 14, 2013.
29. The survey was conducted by J. H. Harris, State Registered Professional Engineer, No. 10000, State of Maryland.
30. The survey was conducted for the purpose of establishing the boundary and easement lines for the Riddle Valley Industrial Park, Inc.

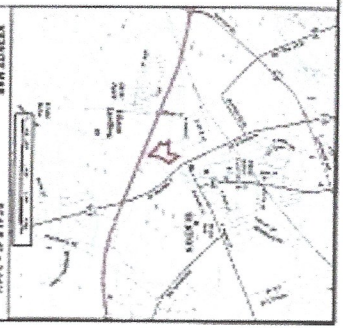

REFERENCE MAP
SCALE: 1" = 200'

APPENDIX
PROPERTY OWNER
RIDDLE VALLEY INDUSTRIAL PARK, INC.
1400 W. MAIN ST.
RIDDLE VALLEY, MD 21134

BOUNDARY SURVEY PLAN
For
RIDDLE VALLEY INDUSTRIAL PARK INC.

804 The Pinyon Square, SE
808 HAZELL STREET
Blacksburg, VA 24060
THE TOWN OF EUREKA, CEEL COUNTY
MARYLAND, 21881
1400 W. MAIN ST.
RIDDLE VALLEY, MD 21134

DATE: 08/14/2013	BY: J. H. HARRIS	PROJECT: RIDDLE VALLEY INDUSTRIAL PARK INC.	SHEET: 01 OF 01
Boundary Survey Plan for Riddle Valley Industrial Park, Inc. Eureka, Ceel County, Maryland			